



100 Terrace St. Roxbury, MA 02130
P: 617-442-2262 F: 617-427-2491

PLAN VIEW

(looking down at the floor)

Scale: 1/2" equals 1 foot. One small square equals 6".

Angles are Easy. Measure where they start and stop on adjacent walls. Connect the two points.

Locate all things that cannot be moved. Examples are: heat registers, radiators, exposed pipes, and openings into other rooms.

Locate all doors and windows. Indicate the total width of the window and doors including the trim. Indicate the swing of the doors using an arrow at the knob side showing the direction of the swing.

Note the ceiling height. _____

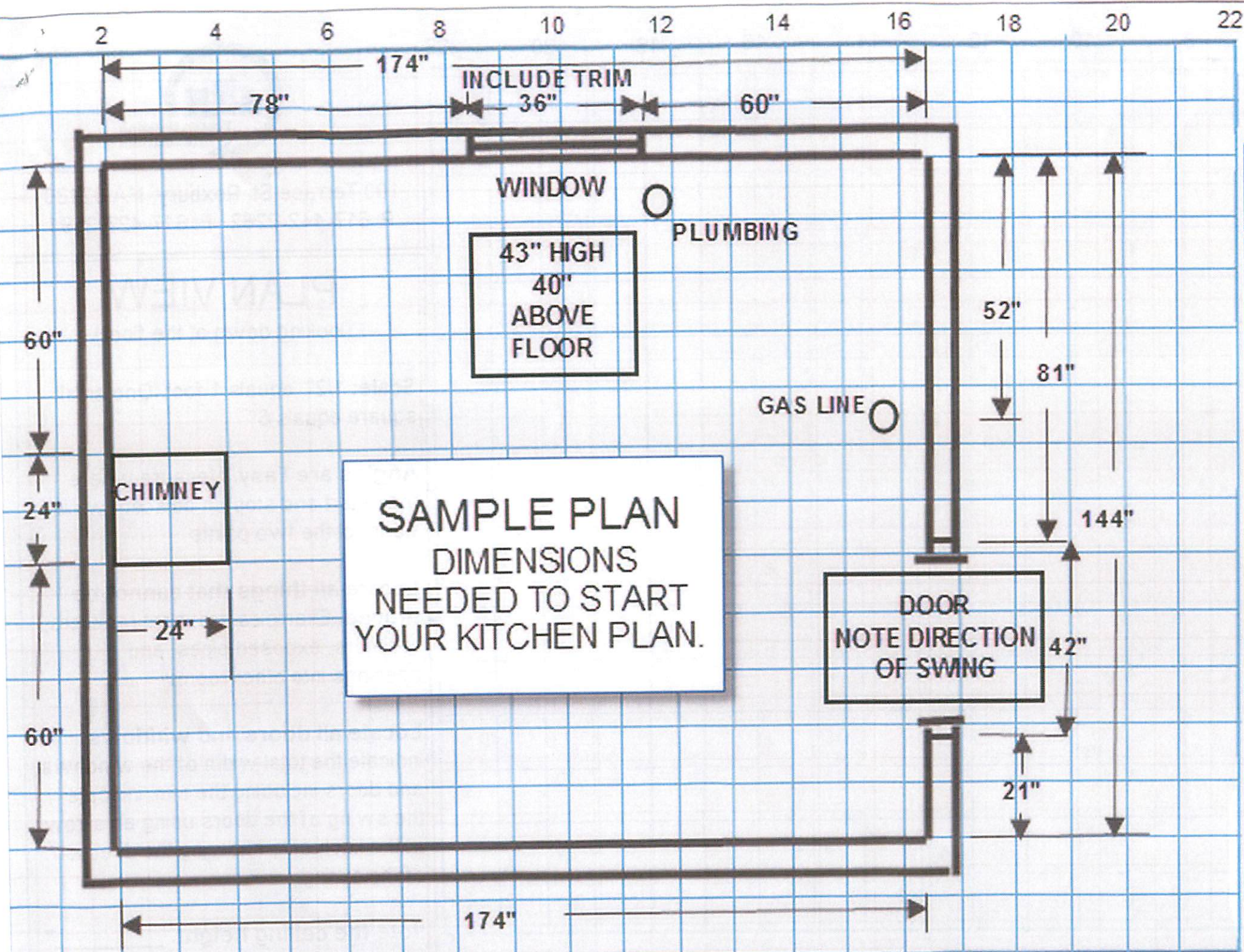

**SAMPLE PLAN
DIMENSIONS
NEEDED TO START
YOUR KITCHEN PLAN.**



100 Terrace St. Roxbury, MA 02130
P: 617-442-2262 F: 617-427-2491

PLAN VIEW

(looking down at the floor)

Scale: 1/2" equals 1 foot. One small square equals 6".

Angles are Easy. Measure where they start and stop on adjacent walls. Connect the two points.

Locate all things that cannot be moved. Examples are: heat registers, radiators, exposed pipes, and openings into other rooms.

Locate all doors and windows. Indicate the total width of the windows and doors including the trim. Indicate the swing of the doors using an arrow at the knob side showing the direction of the swing.

Note the ceiling height. _____"